

Getting started

Electrically operated mortise lock

Touch-to-open



Smart Entrance

BY POLLMEIER

Getting started

Electronically operated touch-to-open mortise lock

Components

SE lock

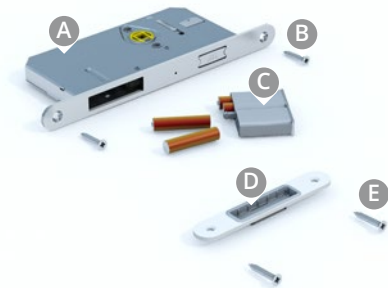

Planum SE handle set*



* The number and type of components may vary depending on the handle set.

Prior to installation

Carefully read the instruction manual!



Installation step 1

Drill/mill holes for handle installation

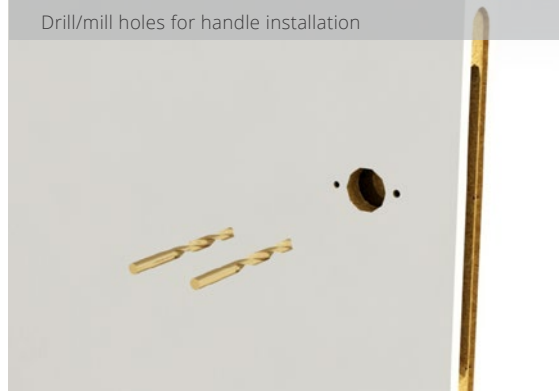

NOTE: refer to the separately enclosed handle guide for the dimensions!

Getting started

Electronically operated touch-to-open mortise lock

Installation step 2

Install the lock without battery compartment

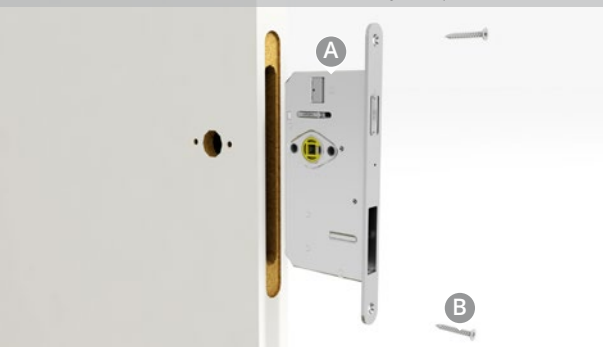

Installation step 3

Install the locking plate and the packing

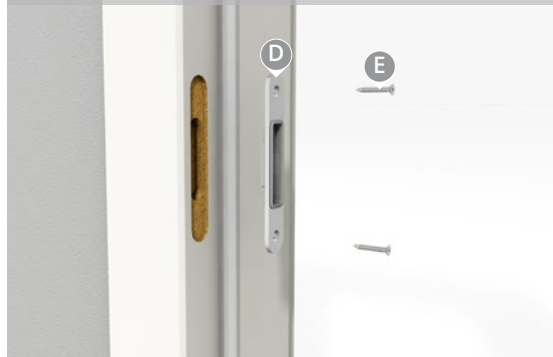

NOTE: turn the packing to vary the clearance of the safety catch by 1 mm and adapt the contact pressure.

Installation step 4

Install the handle



NOTE: please refer to the separately enclosed handle guide for instructions on handle installation!

Installation step 5

Insert 4 x AAA 1.5 V micro alkaline batteries

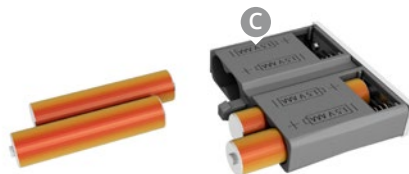

NOTE: ensure correct polarity!

Getting started

Electronically operated touch-to-open mortise lock

Installation step 6

Insert the battery compartment



Installation step 7

Switch on the lock and close the door within 10 seconds after the audible signal



Installation step 8

Do not touch the SE handle for 20 seconds during the calibration process.



Installation step 9

Open the SE handle within 20 seconds of the last, slightly longer beep.



The lock is now ready for operation.



Smart Entrance

BY POLLMEIER